



Sprung
Since 1887

MISSION COMPLETE

How a 225,000 square-foot Sprung structure was built and move-in ready for a world-leading private space exploration company – **in only 11 months.**



OVERVIEW

CLIENT

Blue Origin, a private company that manufactures reusable space-launch vehicles and rocket engines.

CHALLENGE

Their creative and talented workforce grew from 750 to nearly 3000 and counting in less than three years. They needed more space, pronto.

GOAL

Build a high-tech, sustainable facility to inspire and support 1500 team members. It will serve as Blue Origin's new headquarters and R&D space.

SCHEDULE

Eleven months using a Sprung tensioned membrane structure. Conventional construction methods would take approximately three years.



Client	Blue Origin
Industry	Aerospace & Defense
Location	Kent, WA
Building footprint	225,000 Sq. Ft.
Manufacturer	Sprung Instant Structures, Inc.
General Contractor	Sierra Construction Company, Inc.
Architect	NELSON Worldwide

11

MONTHS
TO BUILD

225,000

SQUARE FOOT
STRUCTURE

1,500

EMPLOYEES
TO HOUSE



TIMELINE



In late 2018, Blue Origin evaluates multiple construction options. They choose Sprung Structures for its high performance and ability to meet the tight timeline. A project agreement is reached in December.



TIMELINE: JANUARY 2019 TO DECEMBER 2019



MONTH ONE

Shovels hit the dirt!
The site is readied for building.

JANUARY



MONTH THREE

The structure erection begins.

MARCH



MONTH FOUR

Interior trades work in lockstep behind the build team as the structure is erected. This significantly accelerates the construction timeline and crews are in and out with great efficiency. **Progress is rapid.**

APRIL



MONTH ELEVEN

Construction of the 225,000 sq. ft. insulated Sprung structure is now complete. The remaining interior build-out is finalized.

NOVEMBER



COMPLETE

This project is finished on time and on budget.
Blue Origin celebrates the opening of their new facility.

DECEMBER



OVERVIEW

RESULT

Blue Origin's 225,000 sq. ft. building was completed **on time** and **on budget**.

The space was designed to help employees feel and perform their best.

Features include a garden, fitness facilities, an auditorium and diverse areas to relax, collaborate and socialize with team members from across the company.

Sprung structures provide a large, clear-span space. Open workspaces and areas for large gatherings, such as this auditorium, exist alongside smaller areas better suited to private meetings and focused work.





“This is a very sustainable building with better insulation and better energy consumption than a traditional building. And it all came together very quickly.”

Bob Smith, Blue Origin CEO



Strategically integrated daylight panels and glazing walls provide an abundance of natural light that enhances the interior working environment.

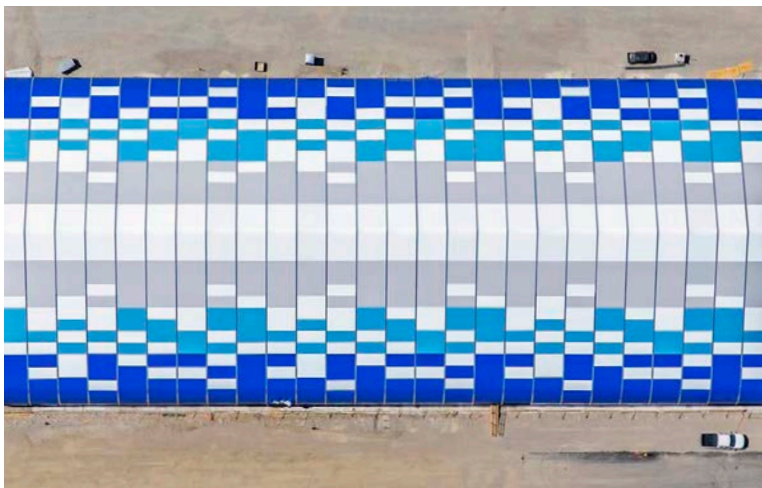

Blue Origin's brand is front and center with a combination of custom color-matched Kynar® and Dupont™ Tedlar® architectural membranes. The design is inspired by human genome DNA sequence patterns.

FEATURES

The structure's unique U-shape makes the most of the site's geography. Its striking silhouette complements the local area.



Seven-layer acoustical insulation in partition walls minimizes noise transfer between the offices, auditorium and fitness facility. Diverse activities can occur without disruption.

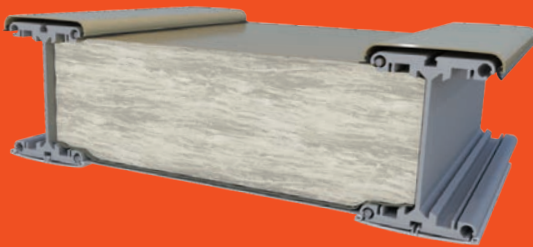

Formaldehyde-free fiberglass insulation and a combination of Kynar® and DuPont™ Tedlar® architectural membranes support Blue Origin's sustainability goals and make for a healthier workplace.

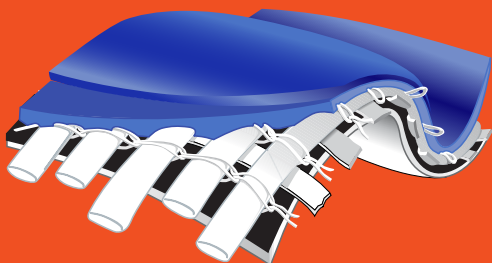

“

It's a fresh and amazing design that brings many teammates together into one space. It feels like the outdoors are indoors, with so much space above and around me.

Team Member, Blue Origin

VISUALS



The airtight, insulated structure offers exceptional energy efficiency. Superior control over the interior environment leads to energy cost savings throughout the building's lifecycle.

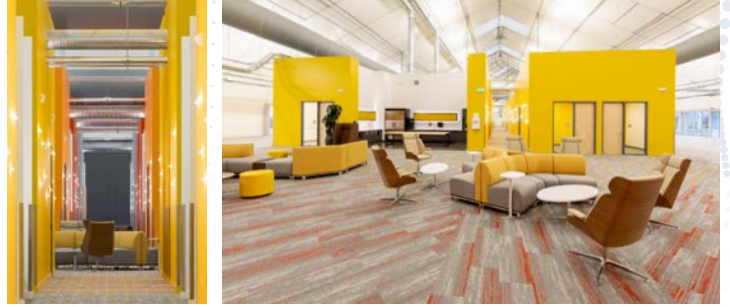

The building features an approximately 10,000 square foot mezzanine.



A full-scale replica of Blue Origin's lunar lander sets the tone for employees and visitors in the HQ's main entrance.

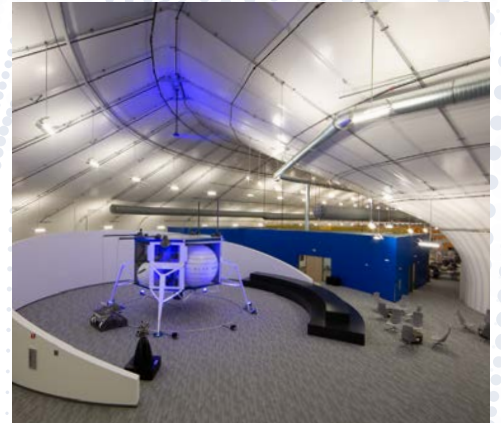

VISUALS



Sheltered within the facility's U-shape, this outdoor garden provides a tranquil area for employees.



More than 100 conference rooms of varying size and function are located throughout the facility.

How a 225,000 square-foot Sprung structure was built and move-in ready for a world-leading private space exploration company – in only 11 months.



Sprung
Since 1887

Sprung Instant Structures, Inc.
5711 West Dannon Way
West Jordan, UT,
United States 84081

Email: info@sprung.com
Toll Free: 1.800.528.9899
Phone: 1.801.280.1555
Fax: 1.801.280.7072

Sprung Instant Structures Ltd.
PO Box 62
Aldersyde, AB, Canada
T0L 0A0

Email: info@sprung.com
Toll Free: 1.800.528.9899
Phone: 1.403.601.2292
Fax: 1.403.601.4833

Sprung Instant Structures E.C.
PO Box 26105
Manama, Bahrain

Email: uae@sprung.com
Phone: +971.508312274

Thank you to our project partners:



Photography by:
Matt Todd Photography